





Pioneer Yard

LEGEND

	Open Assembly Area
	Fabrication Shop
	Blasting & Painting Halls
	Covered Assembly Area

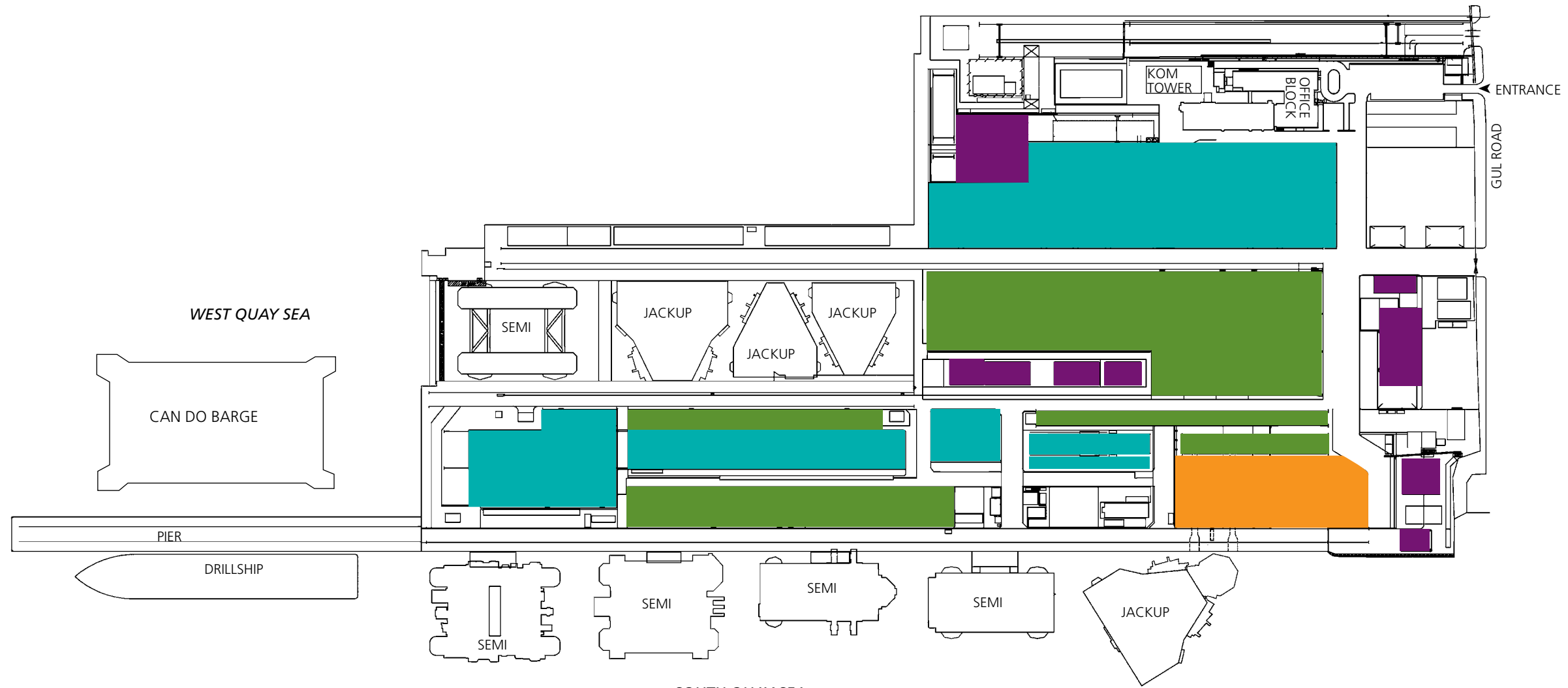

Pioneer Yard II

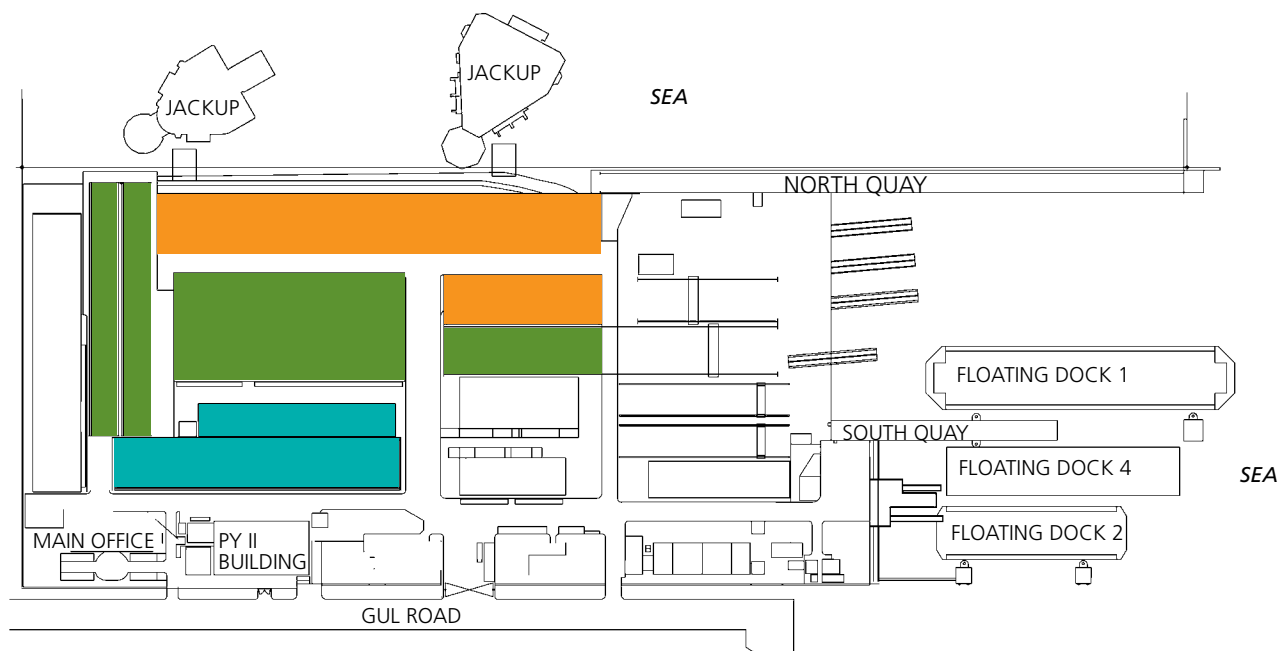

SOUTH QUAY SEA

	Area (m ²)	Outfit quay	
		Length (m)	Depth (m)
Pioneer Yard	280,000	1,400	8 - 11
Pioneer Yard II	140,000	350	4.5 - 6
Main Yard	80,000	500	4.5
Crescent Yard	93,000	740	6

Dry dock with intermediate dock gates

Admiral Dock (400,000 dwt)
380 m x 80 m x 13 m

Total covered shops

42,500 m²

Total open fabrication area

14,900 m²

FELS Can Do Semisubmersible Barge

Lifting capacity of 30,000 MT
138 m x 78 m

Floating cranes

- ✓ Asian Hercules II, 3,200 T
- ✓ Asian Hercules, 1,600 T
- ✓ Asian Helping Hand, 400 T

Other cranes

- ✓ Goliath Gantry Crane, 500 T (100 m span x 57 m hook height)
- ✓ More than 40 mobile and overhead cranes of various descriptions and capacities of up to 300 T

Blasting facilities

- ✓ 9 enclosed blasting and painting halls of between 1,680 m² and 1,800 m²

Cutting facilities

- ✓ CNC cutting machines equipped with oxy-fuel triple rotating cutting torches
- ✓ CNC underwater plasma cutting machines